

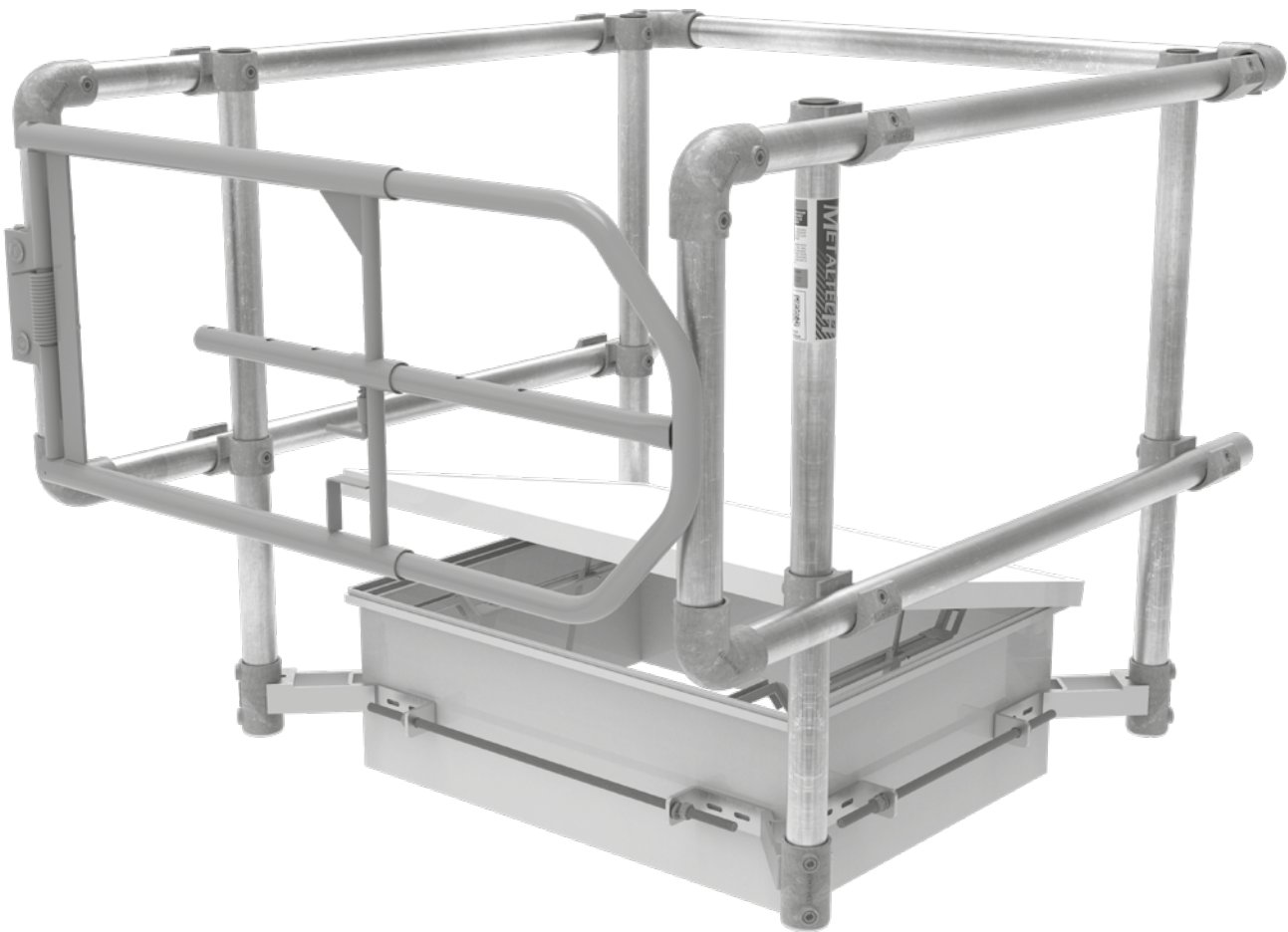

INSTRUCTIONS

ACCESS HATCH



Picture may differ from actual product.



**READ THESE INSTRUCTIONS CAREFULLY BEFORE USING THIS PRODUCT.
KEEP THIS MANUAL HANDY FOR FUTURE REFERENCE.**

**THIS EQUIPMENT MEETS ANSI,
NBC, CNESST, CSTC, RSST,
OBC, OSHA AND WORKSAFE BC
STANDARDS.**

OPERATIONAL SAFETY



READ BEFORE BEGINNING ASSEMBLY.

**FAILURE TO UNDERSTAND AND FOLLOW ALL SAFETY RULES AND ASSEMBLY INSTRUCTIONS
COULD RESULT IN SERIOUS INJURY OR DEATH.**



METAL CONDUCTS ELECTRICITY:

Do not use this equipment where contact may be made with power lines or other live electrical circuits.

INSTRUCTIONS AND SAFETY

- Do not use this equipment if you are in poor health, taking medications, drugs, or have been consuming alcohol, all of which may impair your ability to work safely on this product.
- Comply with local or national legislation that applies for the use of this type of equipment.
- Examine thoroughly to ensure that the guardrails are properly set up.
- Always check that the surface under the foot clamps and/or the guardrail bases are free of debris. Good adhesion is necessary in order to avoid movements or slipping.
- Never use guardrails for purposes they were not intended for.
- Guardrails are not designed and should not be used as a fall protection anchor for workers.
- Inspect before use. Do not use this equipment if it is damaged or missing parts.
- Always inspect equipment before use to make sure it is working properly and that it is suitable for the needs.
- Always wear the mandatory protective equipment when installing guardrails.
- Report and protect access to the site if the installation of the guardrails is not complete and safe.
- It is imperative to use only the manufacturer suggested parts to assemble the guardrails.
- Never use guardrails in poor safety conditions, such as extreme weather conditions.

EQUIPMENT INSPECTION

- The equipment you plan to use should be inspected to make sure it is in good condition and suitable for the job.
Check the following:
 - SILLS: installed in accordance with the assembly guide, respecting the maximum distances and the number of bases.
 - GUARDRAILS: straight, without bumps, deformations or folds and without excessive rust.
 - CLAMPS: must not contain cracks and the fastening screws must be tightened to the specified torque.
 - OTHER COMPONENTS: inspect any other component of the structure. Any damaged part should be labeled and marked as improper for use.

STANDARDS COMPLY*

- The guardrail must withstand a concentrated horizontal load of 1.0 kN to the outside or inside as well as at any point on the guardrail.
- The guardrail must withstand a vertical load of 1.5 kN/m applied to the top rail.

*NBC 2015 - National building code of Canada 2015 - 4.1.5.14

PARTS

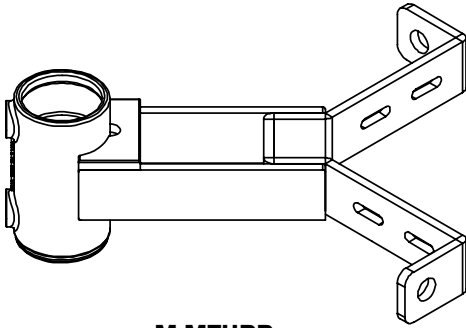

M-MTHBR
CORNER BRACKET



M-MTS04
GUARDRAIL POST

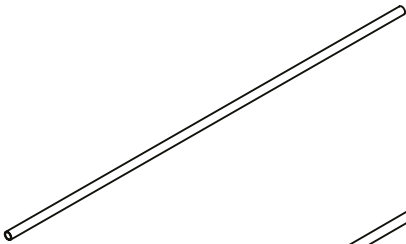

M-MTA120
120 in. GUARDRAIL

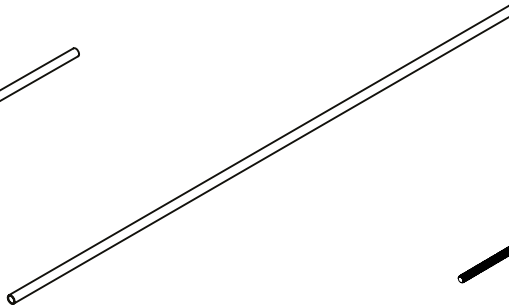

M-MTA240
240 in. GUARDRAIL

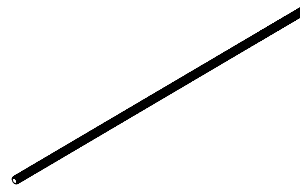

VB-TF1/2X26GV
1/2-13 X 26 IN.
THREADED ROD

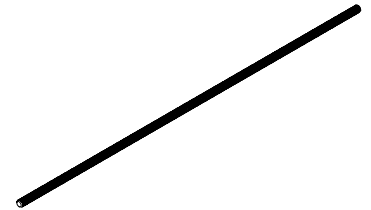

VB-TF1/2X32GV
1/2-13 X 32 IN.
THREADED ROD

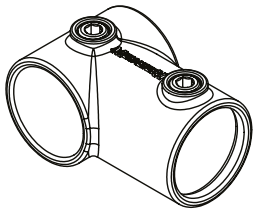

M-MTCT
T-CLAMP

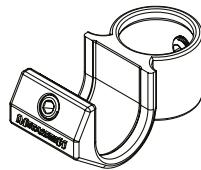

M-MTCH
HOOK CLAMP



M-MTCE
ELBOW



AL-A0050
END CAP

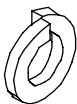

VB-WL1/2GV
1/2 IN. LOCK WASHER



VB-NM20GV
20 mm NUT

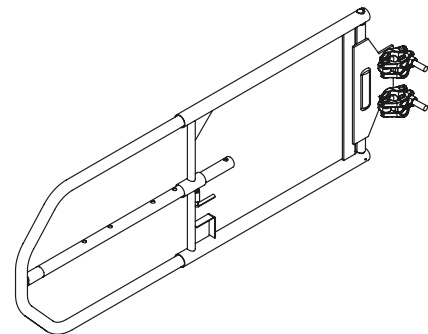

M-MCRG
SWING DOOR

OPTION A TIGHTENING GUARDRAIL

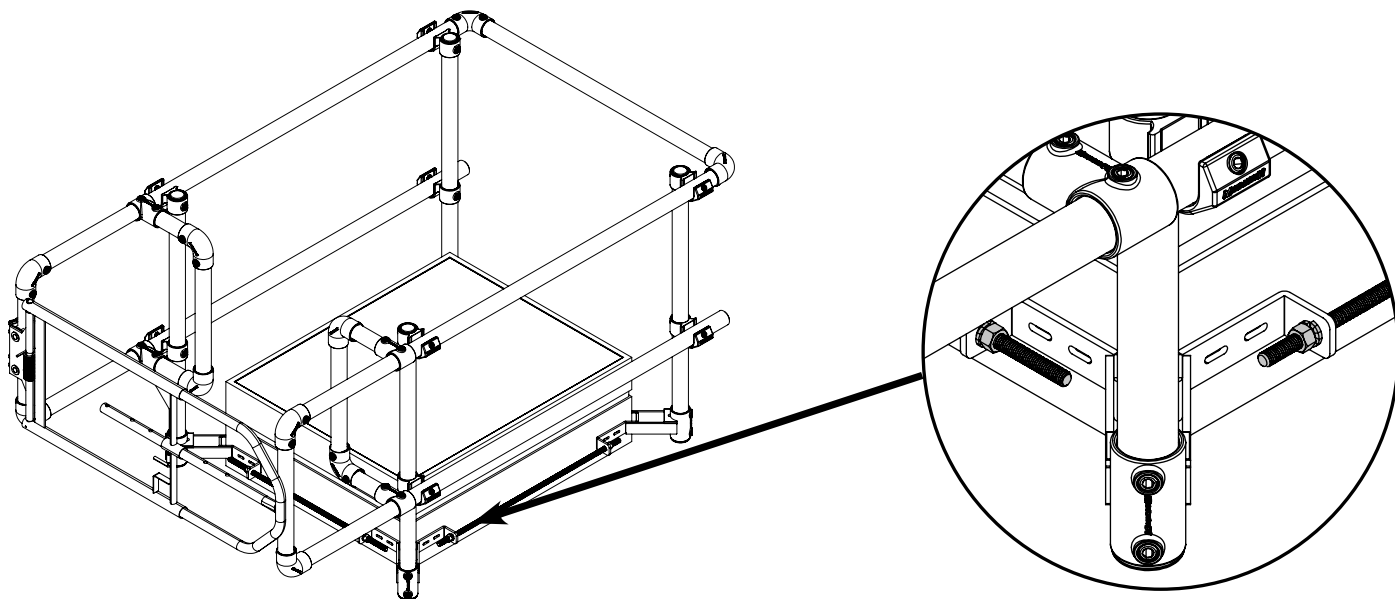

INSTALLATION OF THREADED RODS, CLAMP NUTS AND WASHERS

- 1** Install the clamps and threaded rods in position around the access hatch without tightening the nuts and washers beforehand. Threaded rods can be cut if they are too long during installation.
- 2** When preparation is complete, gradually tighten the nuts and threaded rods alternately on each side of the hatch, making sure the corners stay in place during installation. Make sure the clamps are at the same distance from the ground if your system is not touching the ground (leveling). If necessary, use rubber mats to protect the roof surface below the corner flanges.

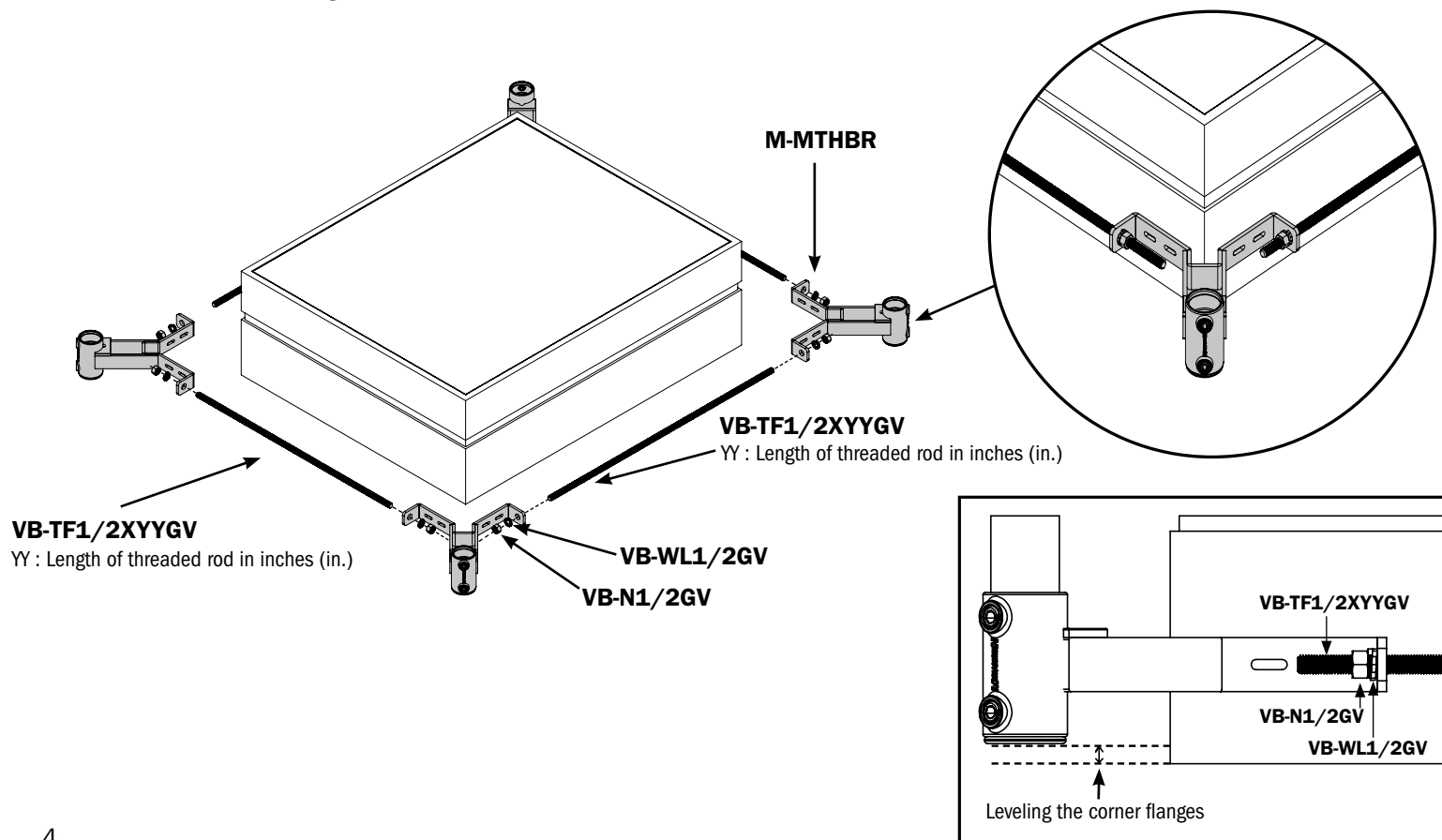

OPTION B ANCHOR GUARDRAIL

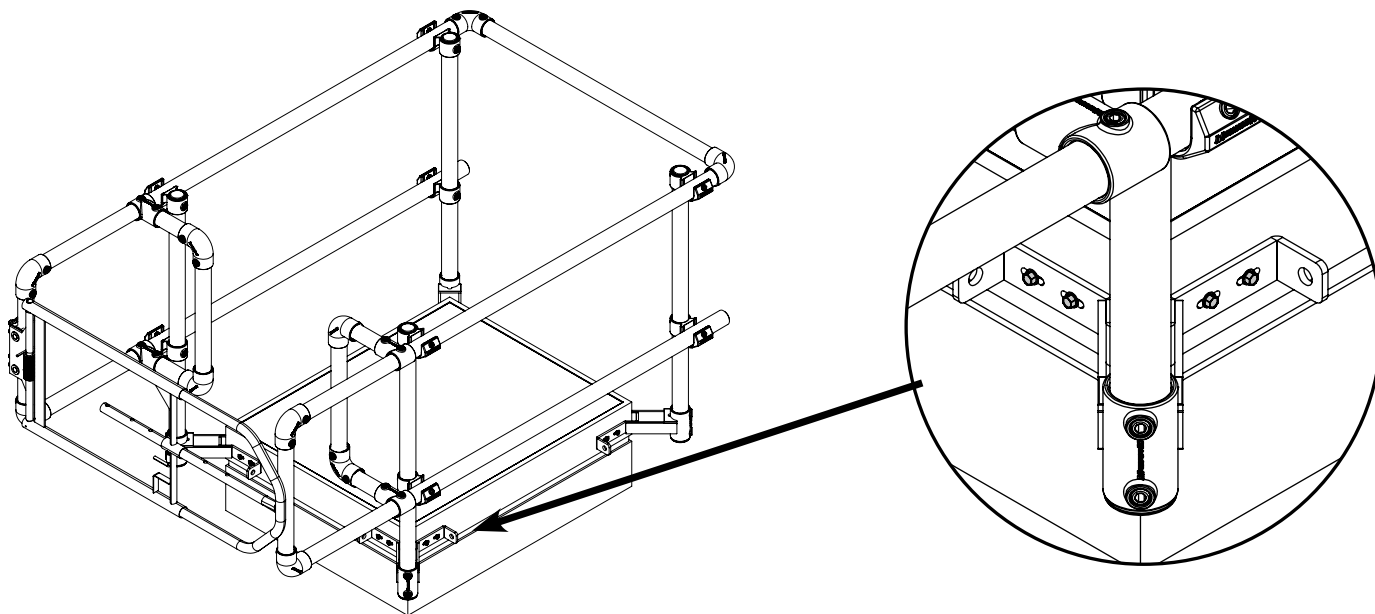

INSTALLATION WITH SELF-DRILLING SCREWS

- 1 Install the clamps in position around the access hatch. Use the self-drilling screws in the oblong holes for this purpose until the flanges are fixed. Make sure that the clamps are as low as possible from the access hatch and at the same distance from the ground.

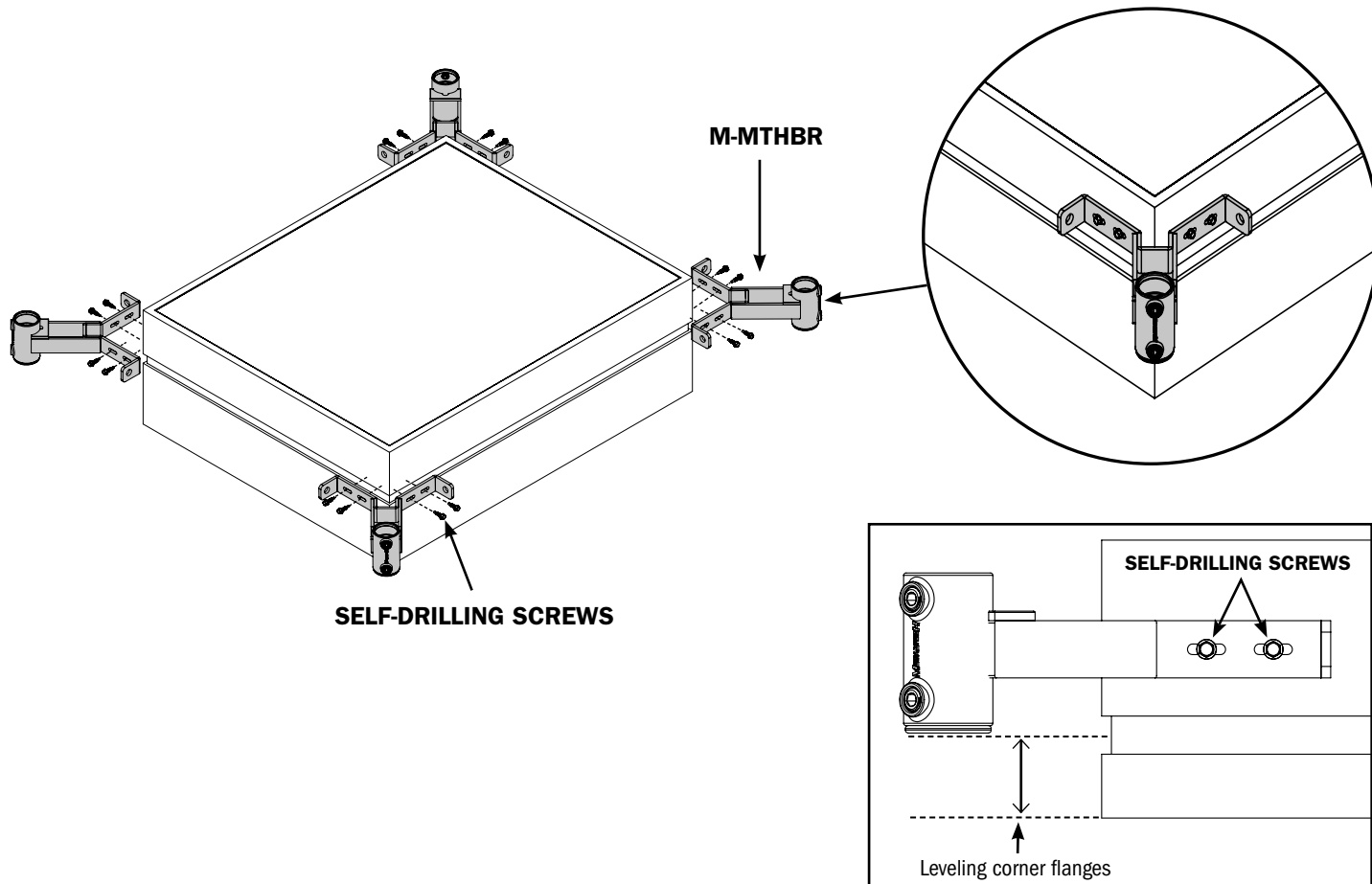

ASSEMBLY OF GUARDRAIL POSTS

- 1** Insert the 4 vertical tubes with the hooks.
- 2** Tighten the fastening screws on each corner clamp to 30 lb-ft (max 37.5 lb-ft).
- 3** Install the caps on top of the vertical tubes.

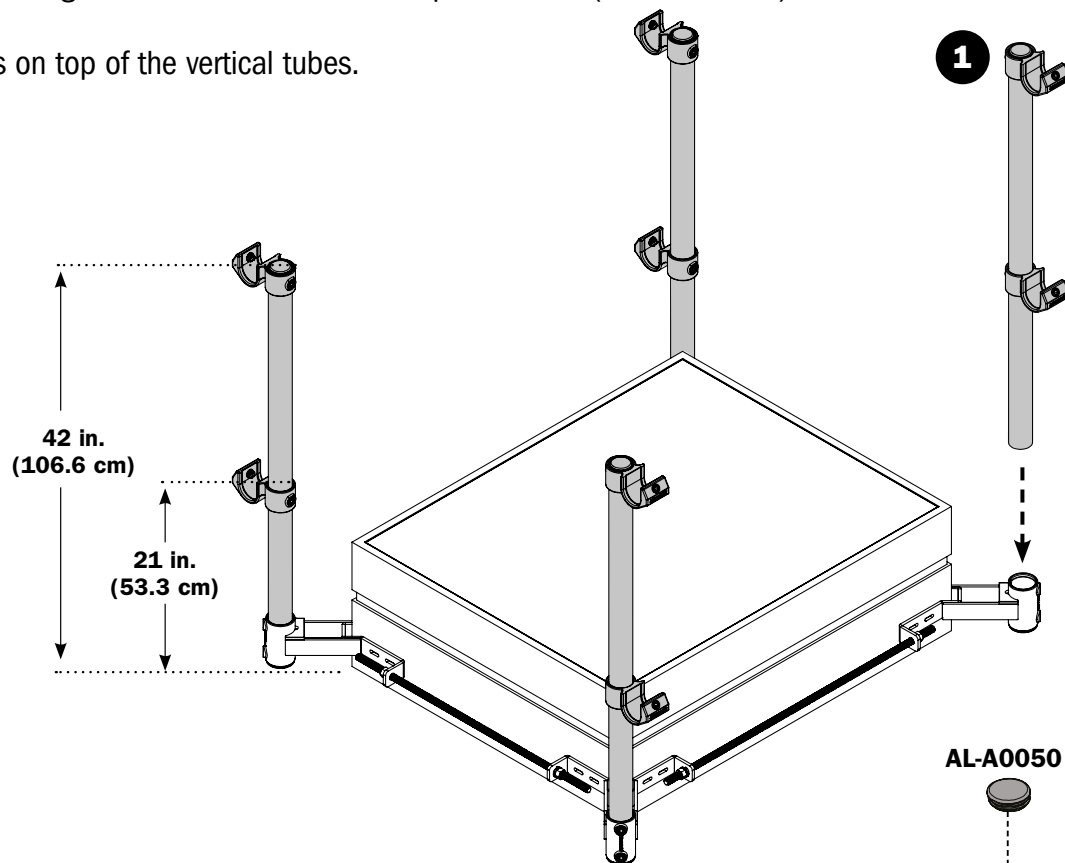

* **Note:** The top rail tube should stand at 42 in. (106.6 cm). The middle rail tube should be at 21 in. (53.3 cm).

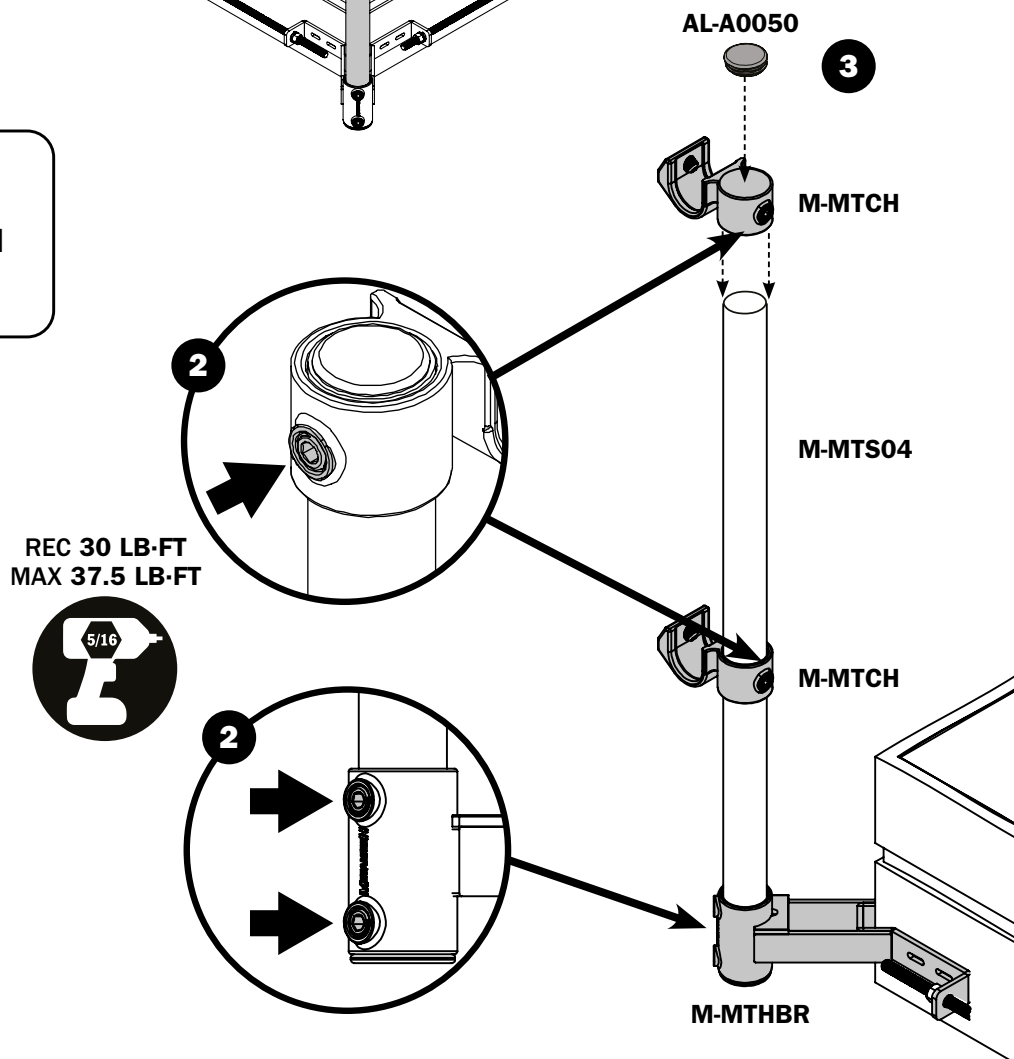

ASSEMBLY OF GUARDRAIL POSTS

- 1** Insert the 4 horizontal tubes of the guardrail on the hooks. The length of the horizontal tubes depends on the optional 2 foot clearance to allow the worker to exit the access hatch.
- 2** Insert the caps at the rear ends of the two intermediate tubes.
- 3** Make sure that the top rail is 42 in. (106.6 cm) from the ground and the middle rail is 21 in. (53.3 cm) from the ground.
- 4** Tighten the front screws to 20 lb-ft (max 25 lb-ft) on all hook clamps once the system is adjusted. It is suggested to use a spirit level during this installation.

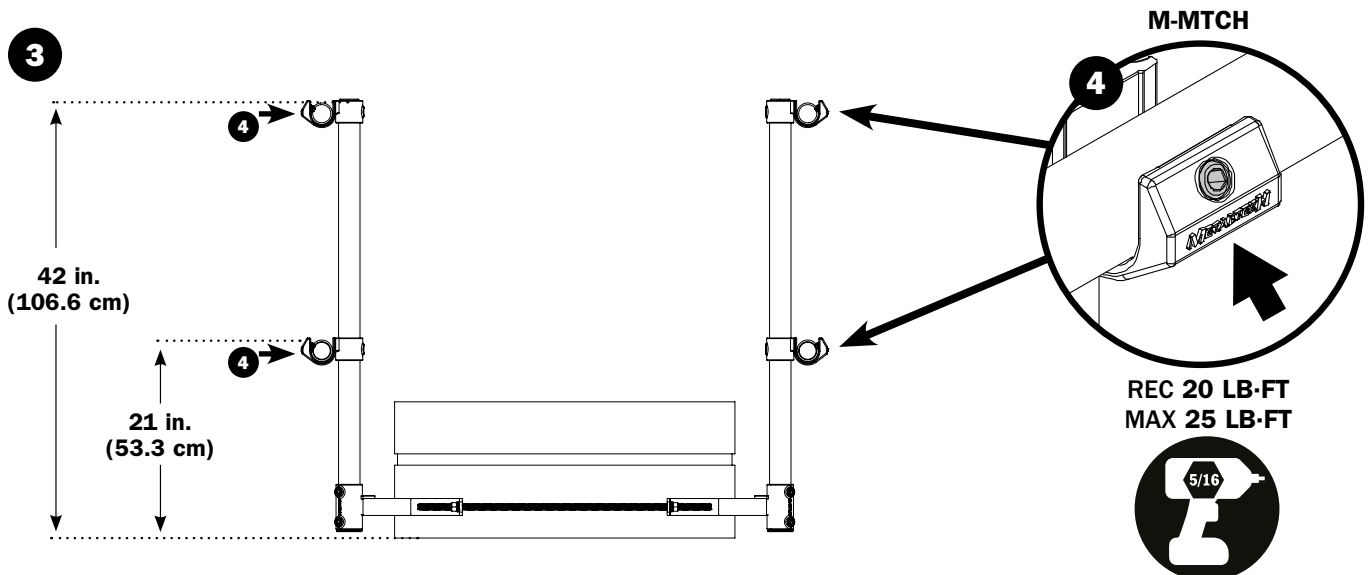
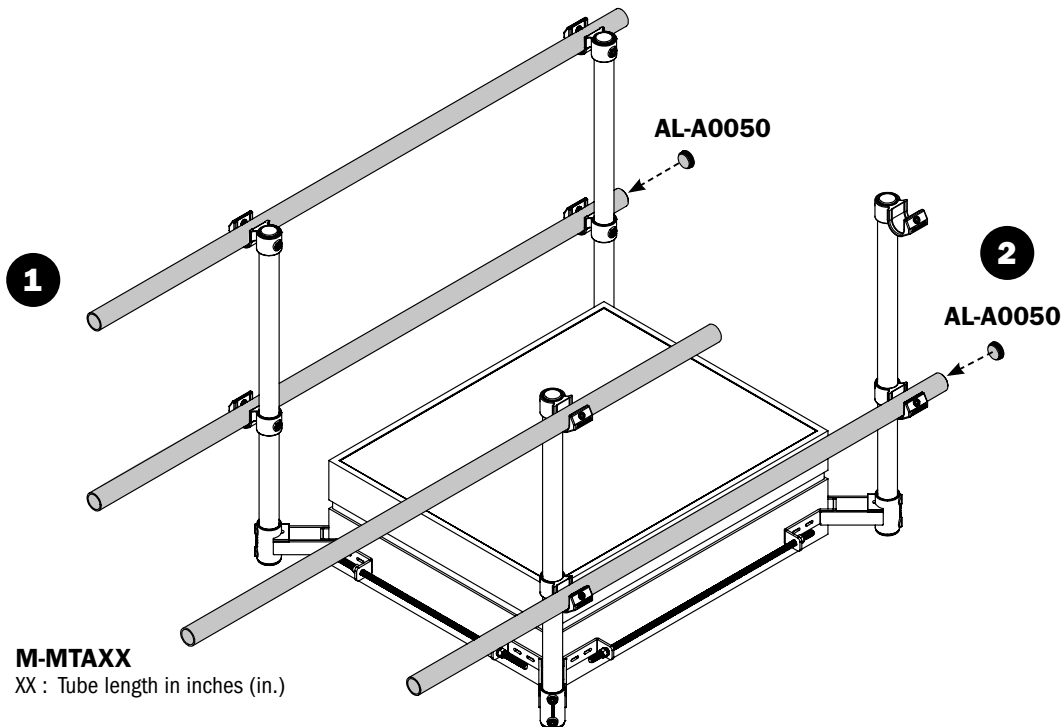

ASSEMBLY OF GUARDRAIL POSTS

Insert an elbow at the rear ends of the top rail. Insert a tube in these 2 elbows. The tube may vary in length depending on the size of the access hatch. If necessary, this can be cut during installation.

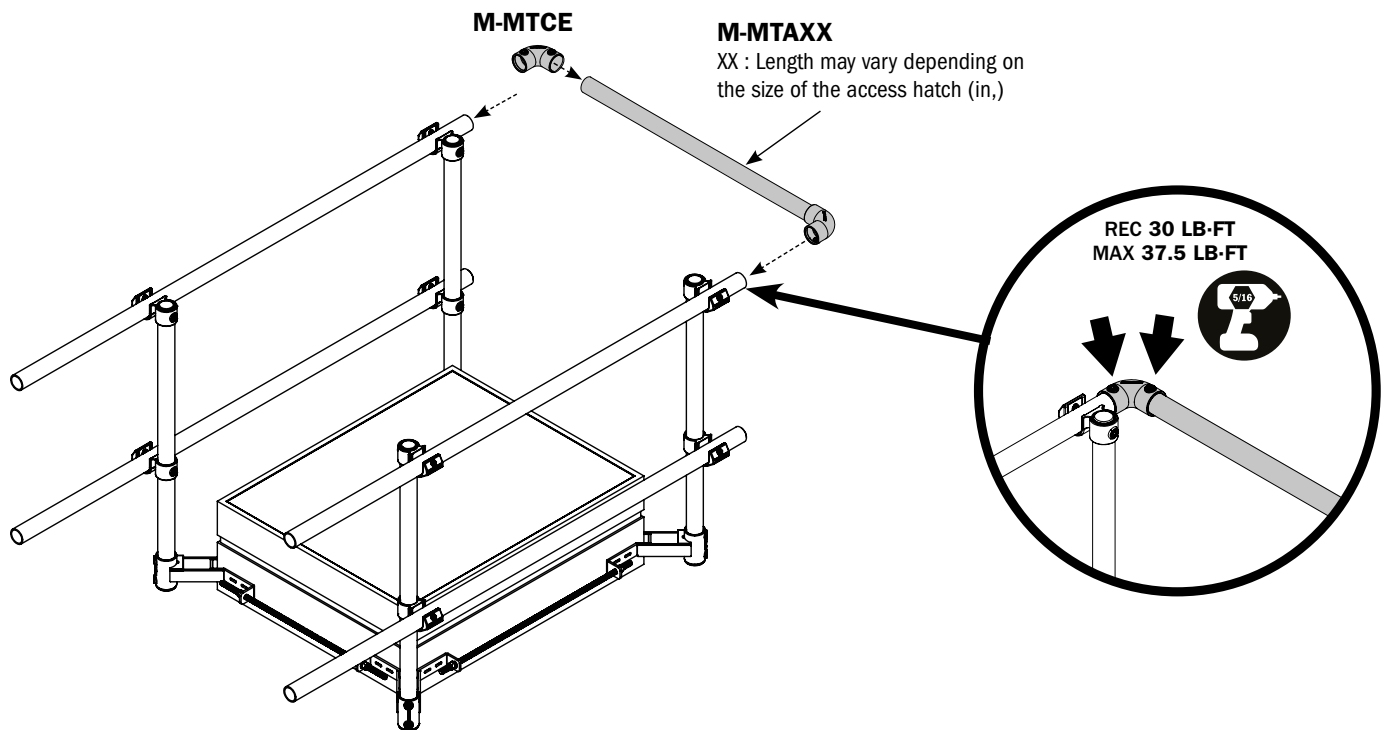

ASSEMBLY OF HANDRAILS

Handrails are also available to help exit the hatch. This handrail must be installed before the door and is made of aluminum tubes and T-clamps. Bring the handrails closer to the vertical posts as much as possible. Tighten the thumbscrews to 30 lb-ft (max 37.5 lb-ft).

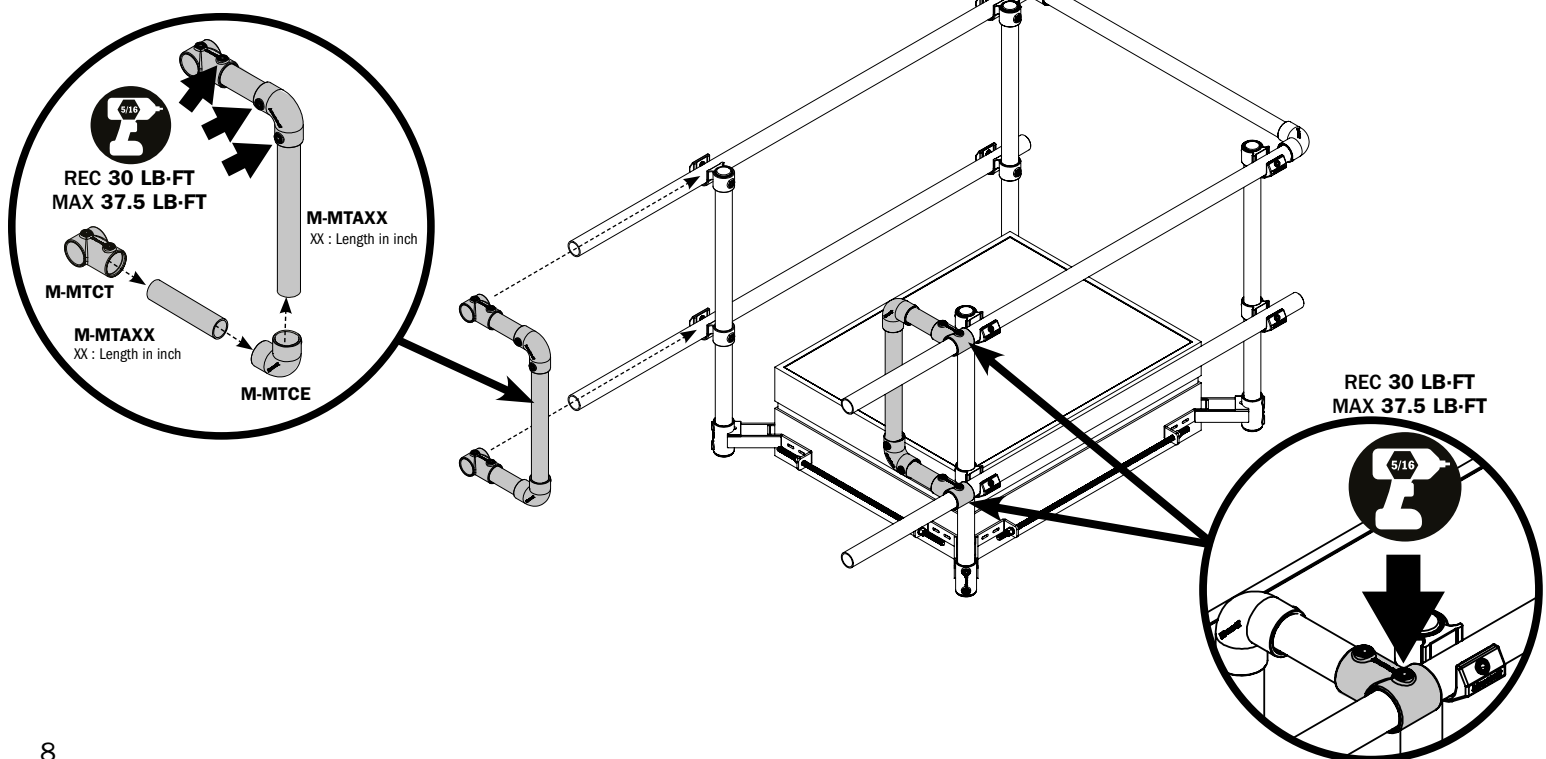

RETRACTABLE DOOR ASSEMBLY

Assemble the retractable door on the guardrail. Tighten the door nuts.
The top rail of the door must be at the same level as the top rail of the guardrail.

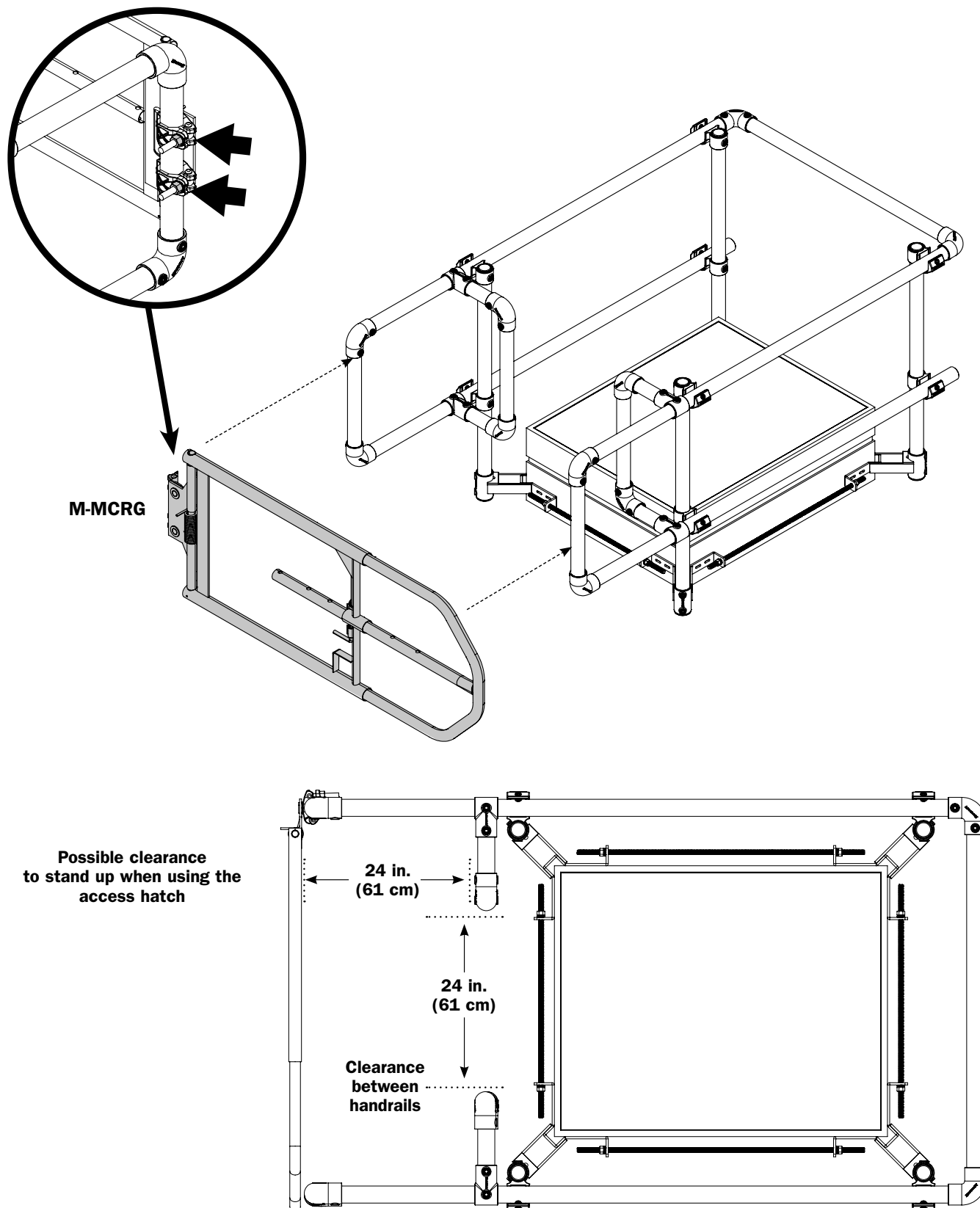

Customer Service

1 800 363-7587

Our customer service staff is available to help you. For help with product assembly, to report damaged or missing parts, or for any other information about this product, please call our toll-free number.

KEEP THIS MANUAL FOR FUTURE REFERENCE

Keep this manual and the original sales invoice in a safe, dry place for future reference.

Ten Years Limited Warranty

Metaltech-Omega Inc. guarantees this product against any material defect. Please return this product, freight prepaid, to Metaltech-Omega Inc. At its own discretion, Metaltech-Omega Inc. will replace or repair this product and return it within a reasonable time. This warranty does not cover any damage(s) caused by any incorrect or inappropriate use, care or maintenance. Proof of purchase must accompany the return.



Metaltech is a registered trademark of Metaltech-Omega inc.

WWW.METALTECH.CO
1 800 363-7587
LAVAL, QUEBEC, CANADA H7L 3N6

IN-MTH-NA-EN05